

## Kitchen Unit Orders

### PLEASE NOTE

The two options available for doors are Wrapped Doors and Melamine Doors. Glass and lattice doors are only available when selecting wrapped doors.

All hardware included but the following must be bought separately:

- Glass
- Handles
- Worktops
- Fillers
- Floorboards
- Cornices

### Floor Units

Depth 540

Height 720

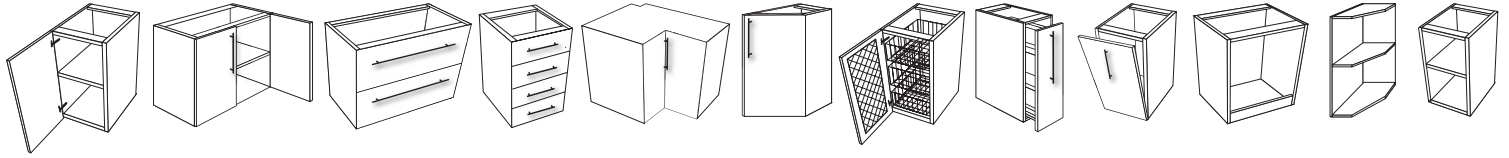

UNIT CODE	DESCRIPTION	WIDTH
F300	Standard 1 door	300 - 600
F650	Standard 2 doors	650 - 950
F300/1	With 1 drawer 1 door	300 - 600
F300/2	With 2 drawers	300 - 950
F300/3	With 3 drawers	300 - 950
F300/4	With 4 drawers	300 - 950
FC800	L-Shaped corner unit	800 900
FC900RIL	Corner reach in opening left	900 - 1200
FC900RIR	Corner reach in opening right	900 - 1200
FCD900	Diagonal door	900
FPS300	Peninsular door on both sides	300 - 600
FPS650	Peninsular door on both sides	700 - 950
FOS300	Open shelves	300 - 950
FES300	End shelves	300
FW300	Wine rack	150 300 450
F300A	With angle door	300
F300SPICE	Spice drawer	150 300
F450POB	Bin unit	450
F450WICK3	3 wicker basket unit	450
F600LAT	Lattice door vegetable unit	300 450 (ONLY AVAILABLE WITH WRAPPED DOORS)
F600UCO	Under counter oven unit	600 730 900

### Tall Units

Depth 540

Height Standard 1940

Medium 2120

High 2300

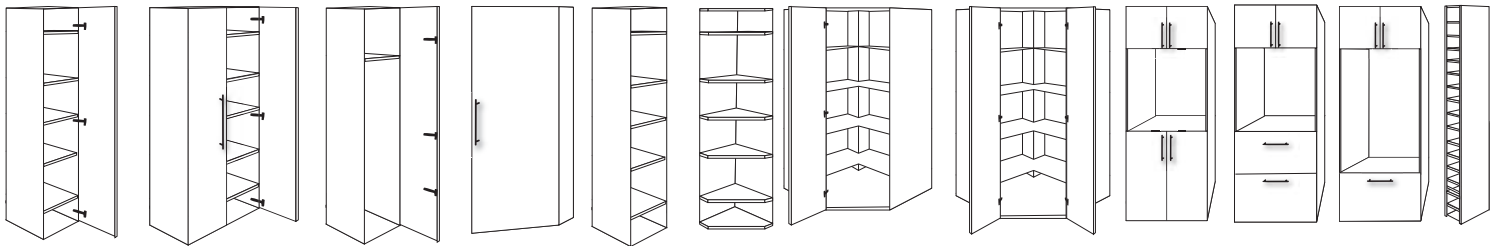

UNIT CODE	DESCRIPTION	WIDTH
TG300	Standard 1 door	300 - 600
TG900	Standard 2 doors	650 - 950
TB300	Broom unit	300 - 600
TA300	With angle door	300
TOS300	Open Shelves	300 - 950
TES300	End Shelves	300
TWR300	Wine rack	150 300
WIP1050/2	Walk in pantry with 2 doors	1050
WIP1050	Walk in pantry with 1 door	900 - 1050
TC 1ELO970-2D2D	Corner Single Eye-level oven 2 doors 2 doors	970 1050
TC 2ELO970-2D2D	Corner Double Eye-level oven 2 doors 2 doors	970 1050
ELO750-2D2D	Eye level oven 2 top 2 bottom doors	600 730 900
ELO750-1P2D	Eye level oven 2 top doors 1 drawer	730
ELO750-2P2D	Eye level oven 2 top door 2 drawers	600 730 900

# Kitchen Unit Orders

**PLEASE NOTE**

The two options available for doors are Wrapped Doors and Melamine Doors. Glass and lattice doors are only available when selecting wrapped doors.

All hardware included but the following must be bought separately:

- Glass
- Handles
- Worktops
- Fillers
- Floorboards
- Cornices

**Wall Units**

**Depth 300**

**Height Standard 720**

**Medium 900**

**High 1080**

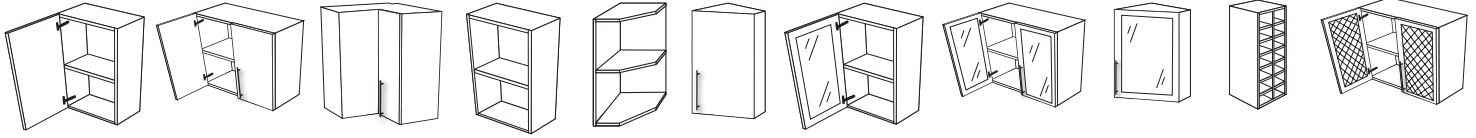

UNIT CODE	DESCRIPTION	WIDTH	HEIGHT
W300	Standard 1 door	300 - 600	720
WM300	Standard 1 door	300 - 600	900
WH300	Standard 1 door	300 - 600	1080
W650	Standard 2 doors	650 - 950	720
WM650	Standard 2 doors	650 - 950	900
WH650	Standard 2 doors	650 - 950	1080
W600EXT	Above Extractor unit 2 doors	600 750 900	240 420 600
WFLP600	1 flap door	300 - 950	240 420 600
W600MICRO	Above Microwave unit 2 doors	600 650 700	360 540 720
WG300	1 glass door	300 - 600	720
WGM300	1 glass door	300 - 600	900
WGH300	1 glass door	300 - 600	1080
WG650	2 glass doors	650 - 950	720
WGM650	2 glass doors	650 - 950	900
WGH650	2 glass doors	650 - 950	1080
W600LAT	1 lattice door	300 - 600	720
WM600LAT	1 lattice door	300 - 600	900
WH600LAT	1 lattice door	300 - 600	1080
W1200LAT	2 lattice doors	650 - 950	720
WM1200LAT	2 lattice doors	650 - 950	900
WH1200LAT	2 lattice doors	650 - 950	1080
WC600	L-Shaped corner unit	600	720
WCM600	L-Shaped corner unit	600	900
WCH600	L-Shaped corner unit	600	1080
WCD600	Diagonal door	600	720
WCDM600	Diagonal door	600	900
WCDH600	Diagonal door	600	1080
WP300	Peninsular doors on both sides	300 - 600	720
WPM300	Peninsular doors on both sides	300 - 600	900
WPH00	Peninsular doors on both sides	300 - 600	1080
WPG300	Peninsular glass door on both sides	300 - 600	720
WPMG300	Peninsular glass door on both sides	300 - 600	900
WPHG300	Peninsular glass door on both sides	300 - 600	1080
WP650	Peninsular doors on both sides	650 - 950	720
WPM650	Peninsular doors on both sides	650 - 950	900
WPH650	Peninsular doors on both sides	650 - 950	1080
WPG650	Peninsular glass door on both sides	650 - 950	720
WPMG3650	Peninsular glass door on both sides	650 - 950	900
WPHG650	Peninsular glass door on both sides	650 - 950	1080
WGA300	With angle glass door	300	720
WGMA300	With angle glass door	300	900
WGHA300	With angle glass door	300	1080
W300A	With angle door	300	720
WM300A	With angle door	300	900
WH300A	With angle door	300	1080
WOS300	Open Shelves	300 - 950	720
WOSM300	Open Shelves	300 - 950	900
WOSH300	Open Shelves	300 - 950	1080
WES300	End Shelves	300	720
WES300M	End Shelves	300	900
WES300H	End Shelves	300	1080
WWR300	Wine rack	150 300	720
WWR300M	Wine rack	150 300	900
WWR300H	Wine rack	150 300	1080

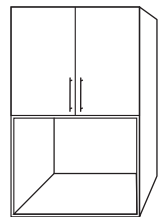

**Microwave Unit**

**Depth 450**

UNIT CODE	DESCRIPTION	WIDTH	HEIGHT
MW600BOX-1	Microwave box only	600 650 700	440
MW600DD	Wall Micro 2 Door	600 650 700	800 980 1160

